





Invitation to

Quark Matter

in

Rio de Janeiro

Several good reasons to have QM in Brazil (South America)

- ▣ QM never came to the south semisphere. Maybe it is the time..
- ▣ Rio de Janeiro is a beautiful and friendly city.
- ▣ Latin American community in high energy strong interaction physics is now relatively large, with participation in LHC and RHIC programs and interests of theorists (string theory, field theory) are also increasing. Also, we started the program, National Network for High Energy Physics, hosted by CBPF will extend a good support.
- ▣ There are many talented, young human resources are still to be explored in our area.
- ▣ New convention center in the downtown in Rio has just been inaugrated, offering more conference sites to accomodate a big conference.
- ▣ We have experiences of organization o f several big conferences in Rio.

Rio de Janeiro the City



- **Cosmopolitan city**
- **Population: less than 8 million people**
- **Beautiful nature with the largest urban forest in the world, 2 bays, lagoons, 90 km of beaches and mountains**
- **Climate - mostly sunny, warm to hot, 25- 30°C in fall and spring times (Sep-Oct, March-April)**

Rio is beautiful



Rio de Janeiro access



- 24 international and national airlines link Rio de Janeiro to the main capitals in the world;
- Aproximate number of direct fligths per week:
 - 70 – North and Central America,
 - 80 – Europe,
 - 50 - South America,
 - 7 – Asia,
 - 1 - Africa

Rio de Janeiro infrastructure



- 23,000 hotel rooms, facilities and services for meetings and events;
- Scientific center – 141 scientific institutions, some among the oldest in Brazil;
- Cultural center - museums, cultural centers, theatres, historical buildings;
- Great choice of restaurants, tourists sights, etc.

Invitation to Rio....



Invitation to Rio....



Organization

Co-chairs

- ▣ T. Kodama – Univ. Federal do Rio de Janeiro
- ▣ A. Szanto Toledo – Univ. São Paulo

Brazilian Institutions involved

- ▣ Federal University of Rio de Janeiro - UFRJ
- ▣ Centro Brasileiro de Pesquisas Físicas - CBPF
- ▣ University of São Paulo - USP
- ▣ University of Campinas - UNICAMP
- ▣ State University of São Paulo – IFT/UNESP
- ▣ State University of Rio de Janeiro – UERJ

Collaborations – STAR, PHENIX, ALICE, ATLAS,
CMS (also LQCD group)

Size of Community: ~150 with students

Timing

Fall 2011 or Spring 2012

Both are excellent seasons !

Conference Site

3 options available:

A. Atlantic Hotel - Buzios

B. Sofitel - Copacabana

C. Solar Convention Center - Downtown

Plan A



Atlantic hotel - BÚZIOS

Buzios



3 hours drive to the East of Rio

Búzios



Just 170 km from Rio de Janeiro, a pleasant 2 hours trip by road takes you to the peninsula of Búzios, whose magnificent beaches and crystal-clear water contrast with the exuberantly sculptured landscape and exotic vegetation, which a prodigal "Mother Nature" has privileged with a wonderful year-round summer.



Conference Hotel



Infrastructure



- 1) 3 Auditoria - convertible size, support maximum 1000 sheets
- 2) Pool
- 3) Support rooms

Nearby hotels



Pousada Bucaneiro

Single & double

U\$ 40.00

Include Buffet Breakfast

4 nights double room

U\$ 80.00/ person

Nearby hotels



Nikki Beach

Single U\$ 188,00

Double U\$ 215,00

Include Buffet Breakfast

4 nights double room

U\$ 430.00/ person

Nearby hotels



Pousadas Águas Claras

Single & Double
U\$ 70.00

Include Buffet Breakfast

4 nights double room
U\$ 140.00/ person

Nearby resort town

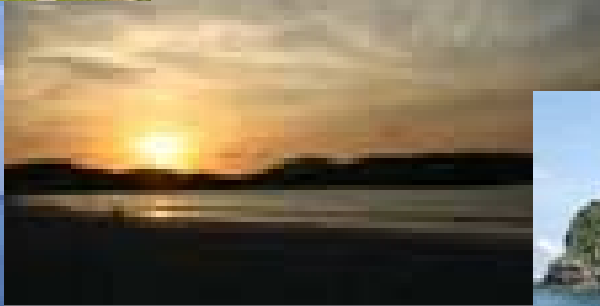

WELCOME TO CABO FRIO

Plan B: Sofitel at Copacabana



Sofitel – Copacabana



Infrastructure of Sofitel

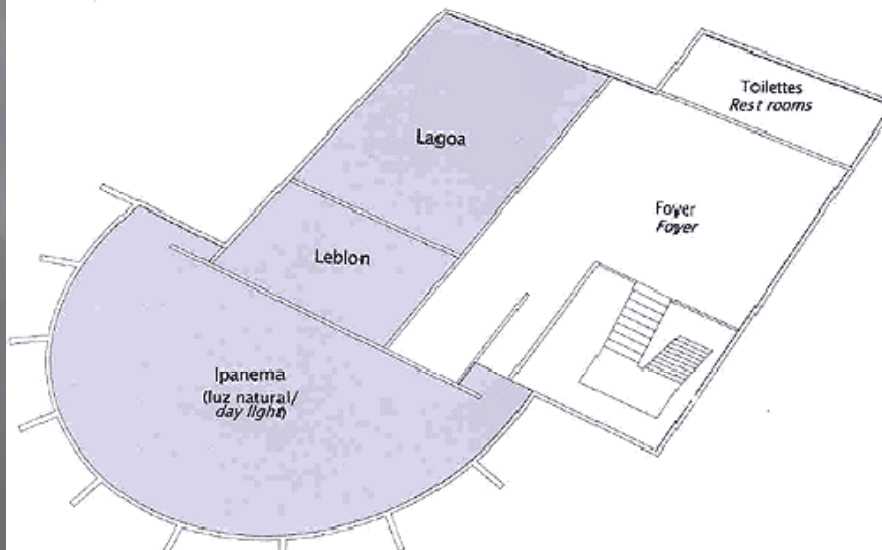
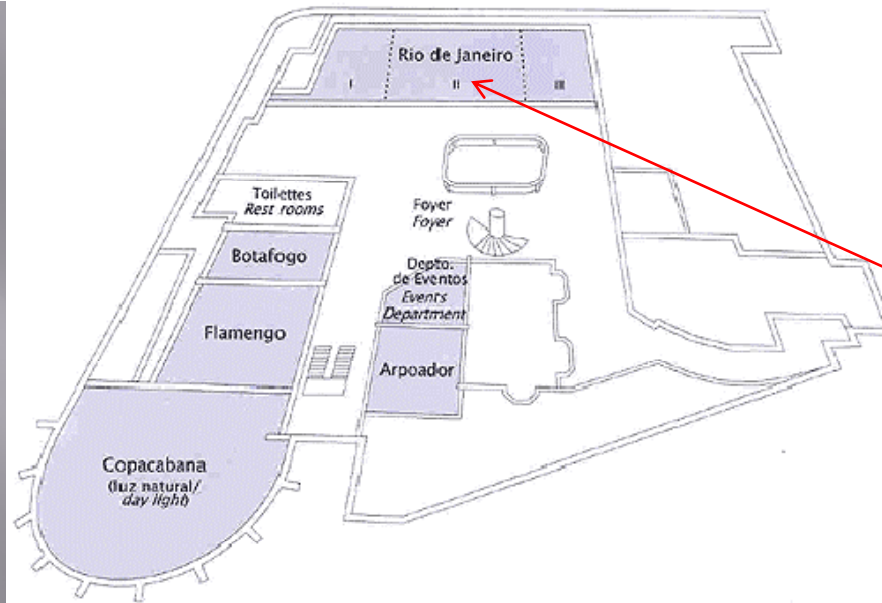

Auditorium
900 persons

Plan C: Sul America Convention Center at Down town (NEW)



Sul America Convention Center (Rio Prefecture)



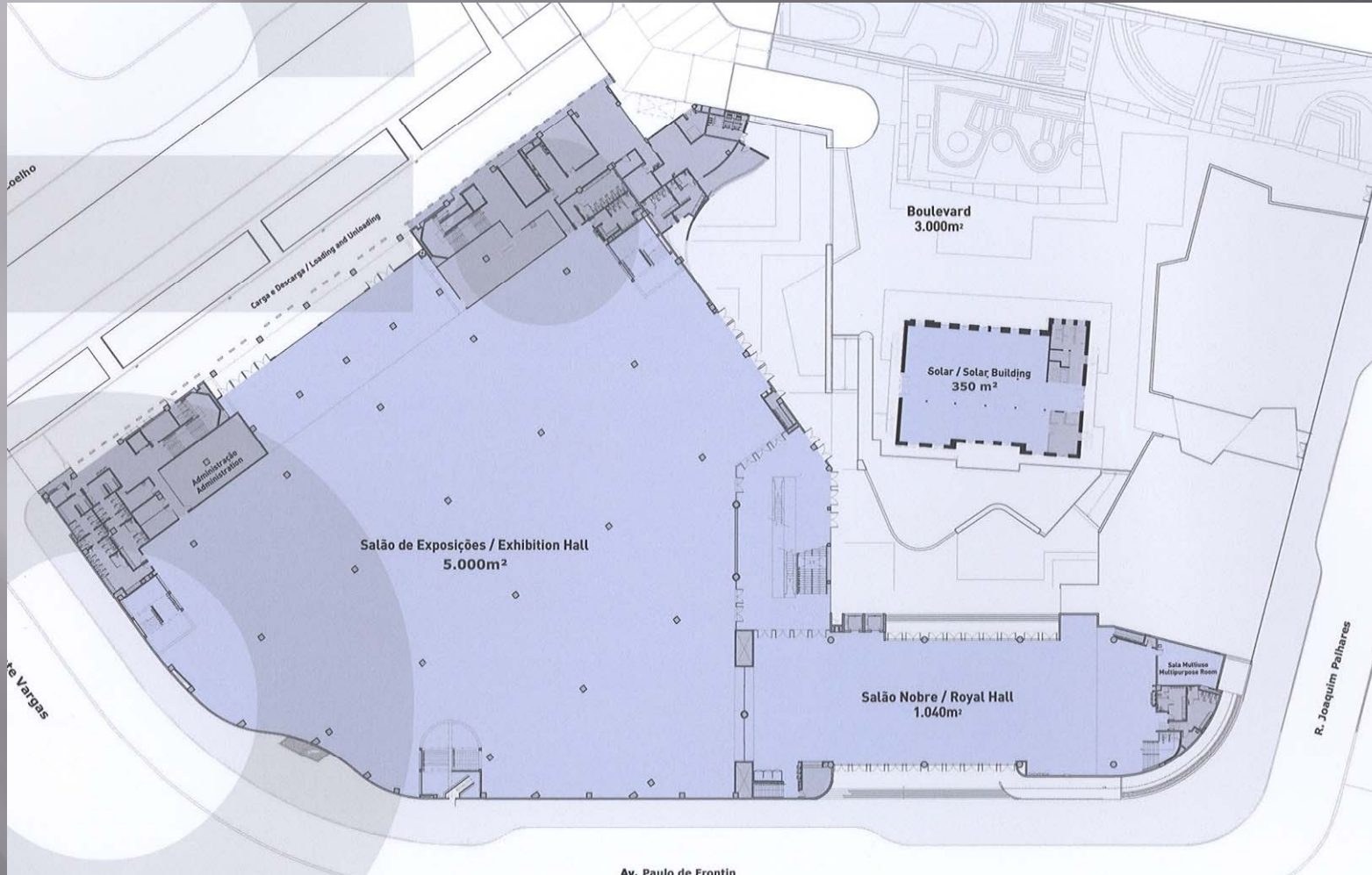

Av. Paulo de Frontin

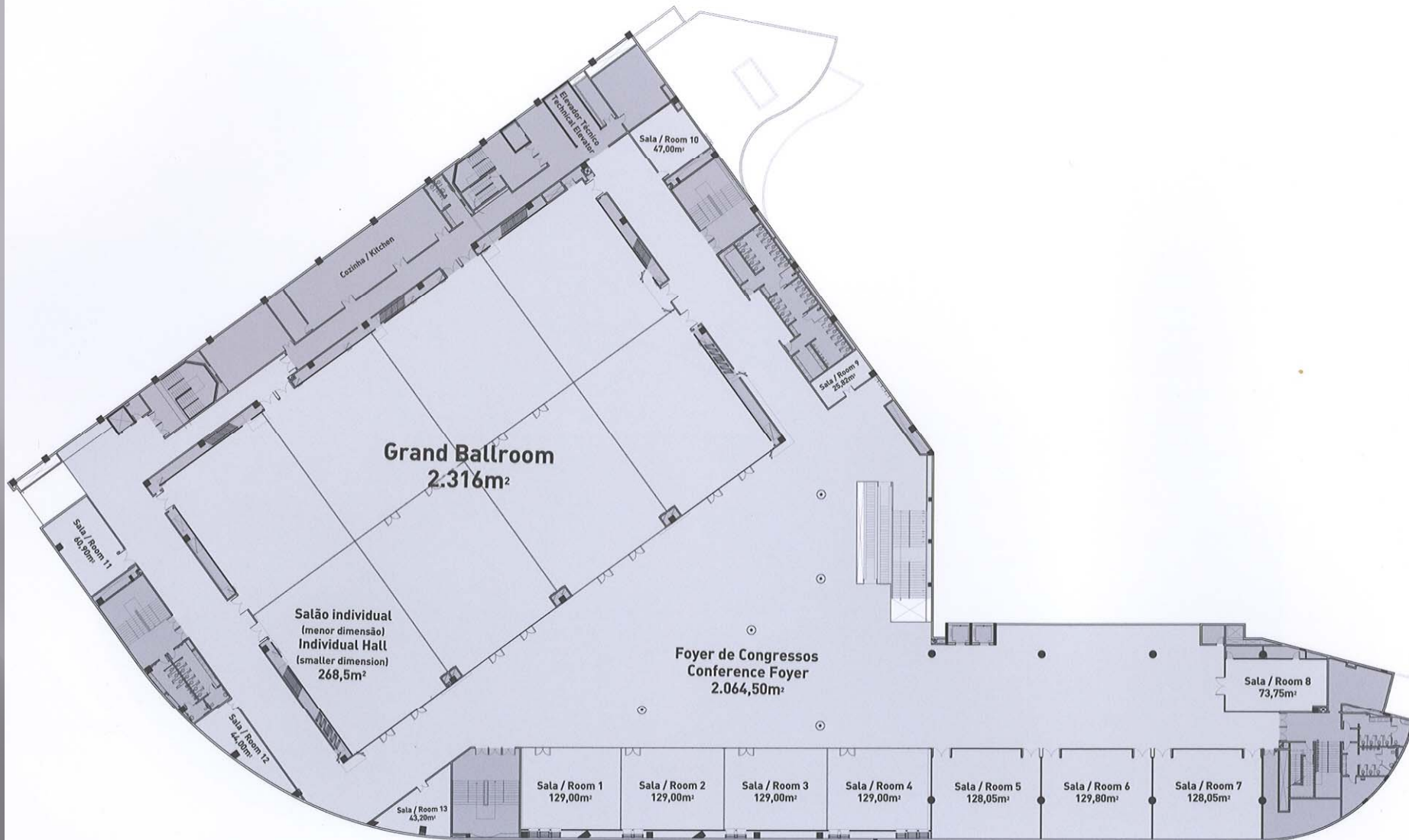

PRO and AGAINST

	Pro	Against
Buzios	Quiet, Concentration, Security high	Connection by bus Not many options for excursion (cruiser, diving)
SOFITEL	No needs for transports De Luxe Many large city options	Expensive Max<900
Convention Center	Very large space Less expensive	Need transport Time loss

Budget estimate (pessimistic)

Registration Fee	500x700=350.000	Lunch, reception	120.000
CNPq	10.000	Administration	45.000
FINEP	15.000	Conference Material	3.500
FAPERJ	10.000	Auditorium+ Transport	150.000
FAPESP	10.000	Proceedings	35.000
UFRJ	2.000	Students support	49.000
CBPF	3.000		
BB	2.000		
Total	402.000		402.000

Still from CLAF, CNEN, and from exteriors

Security problem

- ▣ In fact, Rio is not perfectly secure.
- ▣ However, if you are aware of what NOT to be done, there will be no problem.
- ▣ And

Security problem

